

3 Layers Ropes Course

It is designed for various placement options and environments. It is the perfect option which maximizes limited spaced area. It provides 6 poles, 7 poles, 8 poles 11 poles and more to meet customer's requirements.

Introduction

This course is for those with a significant amount of traffic that want to go to multiple levels. As with all the courses it can be built for indoor playground or outdoor amusement park .The High ropes courses are based on an equilateral triangle or a square or rectangular pole system. We currently have courses that are designed from 6 to more poles and incorporate a diverse range of challenge elements between each pole.

They have proved to be very successful and a big hit in shopping centers or amusement park. The multiple level course options allow participants to progress through each level starting with the lowest to build up their confidence before testing their nerve on play activities above the ground..

The course can be further expanded after installation with additional poles and levels.

Specification

Poles	Elements	Space between poles(m)	Height(m)	1st Platform height(m)	2nd Platform height(m)	3rd Platform height(m)	Capacity
6	27	6	12.3	2.0~3.3	4.6~6.3	6.4~9.3	45 person
7	33	6	50 person				
8	36	6	50 person				
8	39	6	55 person				
11	59	6	12.6				100person

more	more						more
------	------	--	--	--	--	--	------

Features

Customize	1.type 2.size 3.color 4.Play Activities
Size	Different models of different sizes
Material	High strength steel, Wood - Pine , Bangkirai,Lauan, PP rope, Static rope
Standard feature	<ol style="list-style-type: none"> 1.Steel climbing stair 2.Elements or ropes activities 3.Appropriate amount of harnesses for kids or adults. 4.Appropriate amount of Lanyards. 5.Appropriate amount of Triple Step Karabiners. 6.Operator training video or manuals 7.Platform height – Customized or designed as per your site’s height by us
Optional	<ol style="list-style-type: none"> 1.Customerized color for steel frame 2.Themes – Tropical, pirate, Jurassic 3.Yellow or Orange static rope 4.Sun shades 5.Additional PPE 6.Installation Guide at your site 7.Operator trainer training at your site 8.Maintenance and inspection training at JP Development after 1 year of course operation
Delivery time	30 work days

Payment terms	T/T 30% deposit before production, 70% balance upon the copy of B/L
Package details	Air bubble and wood box
Warranty	1 year on steel frame
Service	1.Business Plan; 2.Concept plan or design ; 3.Production 4.Installation Video/Manual; 5.Training Manual ;6.Maintenance & Inspection Manual
Certificate	CE & ISO 9001:2008, ISO 14001:2004 , ISO 18001:2007
Advantage	<ol style="list-style-type: none"> 1. High Strength steel frame; 2. Low investment, High capacity and throughput, 3. Continuous safety belay track system; 4. Proven safety record; 5. Interchangeable elements: 6. Expandability: 7. Competitive and interesting: 8. Site Flexibility:

Installation



Transportation



6 poles Ropes Course

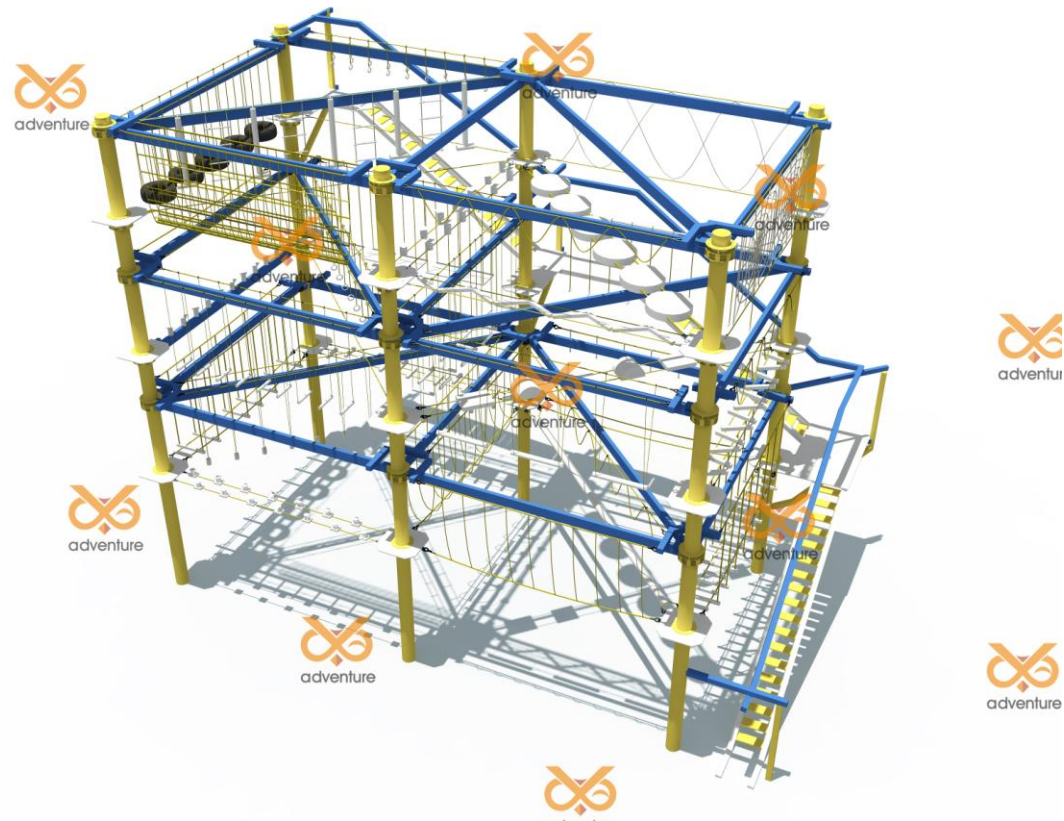

Spec.:

27 play elements

Isosceles right triangle steel structure, 6 poles

Cross-brace

Span between poles are 6m

Course height: 12.3m

1st platform height: 3.3m
2nd platform height: 6.3m
3rd platform height: 9.3m

7 poles Ropes Course



Spec.:

33 play elements

Equilateral triangle steel structure, 7 poles

Cross-brace

Span between poles are 6m

Course height: 12.3m

1st platform height: 3.3m

2nd platform height: 6.3m

3rd platform height: 9.3m

8 poles Ropes Course



Spec.:

39 play elements

Isosceles right triangle steel structure, 8 poles

Cross-brace

Span between poles are 6m

Course height: 12.3m

1st platform height: 3.3m

2nd platform height: 6.3m

3rd platform height: 9.3m

International Version Ropes Course



Spec.:

59 play elements

Equilateral triangle steel structure, 11 poles

Cross-brace

Span between poles are 6m

Two Interactive net attraction activities

Course height: 12.6m

1st platform height: 3.3m

2nd platform height: 6.3m

3rd platform height: 9.3m

6 poles Ropes Course



Spec.:

23 play elements

Isosceles right triangle steel structure, 6 poles

Span between poles are 3.4m

Two Interactive net attraction activities

Course height: 7.8m

1st platform height: 1.2m

2nd platform height: 3.4m

3rd platform height: 5.6m